



# MANHATTAN

2036 SQFT

3



3



**FEATURES:**

- 9' main floor ceiling
- Side entrance to unfinished basement
- Double garage attached
- Two-tone kitchen cabinets to ceiling
- Quartz countertops
- LVP flooring on main floor
- Open to below great room
- Den and full bathroom on main floor
- Elevation or exterior layout (shown above) subject to changes to comply with developer guidelines; rendering is not final
- Exterior colours to be selected by builder to comply with developer guidelines
- 28 pocket lot

**NOTES:**

---



---



---



---



---

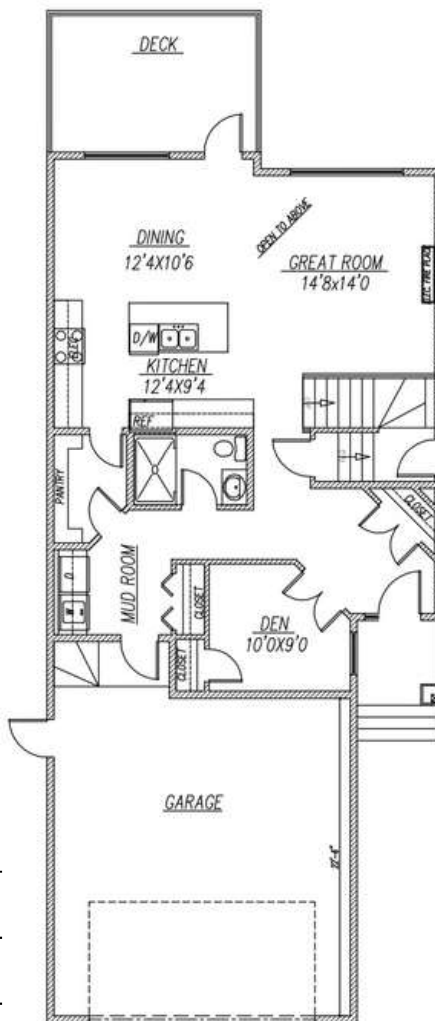

**MAIN - 1000 SQFT**

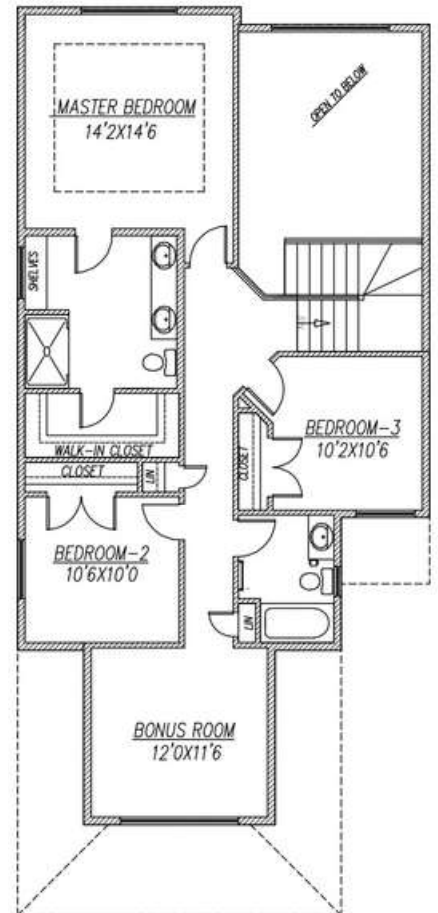

**UPPER - 1036 SQFT**



[www.happyplanethomes.com](http://www.happyplanethomes.com)  
[info@happyplanethomes.com](mailto:info@happyplanethomes.com)  
 8098 Kiriak Link SW, Edmonton, Alberta